

The 2012 Art League Patrons' Show Seating Chart

To make the event safer and more enjoyable for everyone, we provide reserved seating for the Patrons' Show. You will select your preferred seating area when you purchase your ticket. Tickets will be stamped indicating your seat reservation. The floor will be taped, designating each seating area. Each ticket holder will be assigned one seat. Seating for non-ticket holders may be purchased for an additional **\$25**. To give priority to Patrons' Show ticket holders, seating for non-ticket holders is limited to one additional seat per ticket, available on a first come first serve basis.

Please note the change in screen and announcer position for 2012!

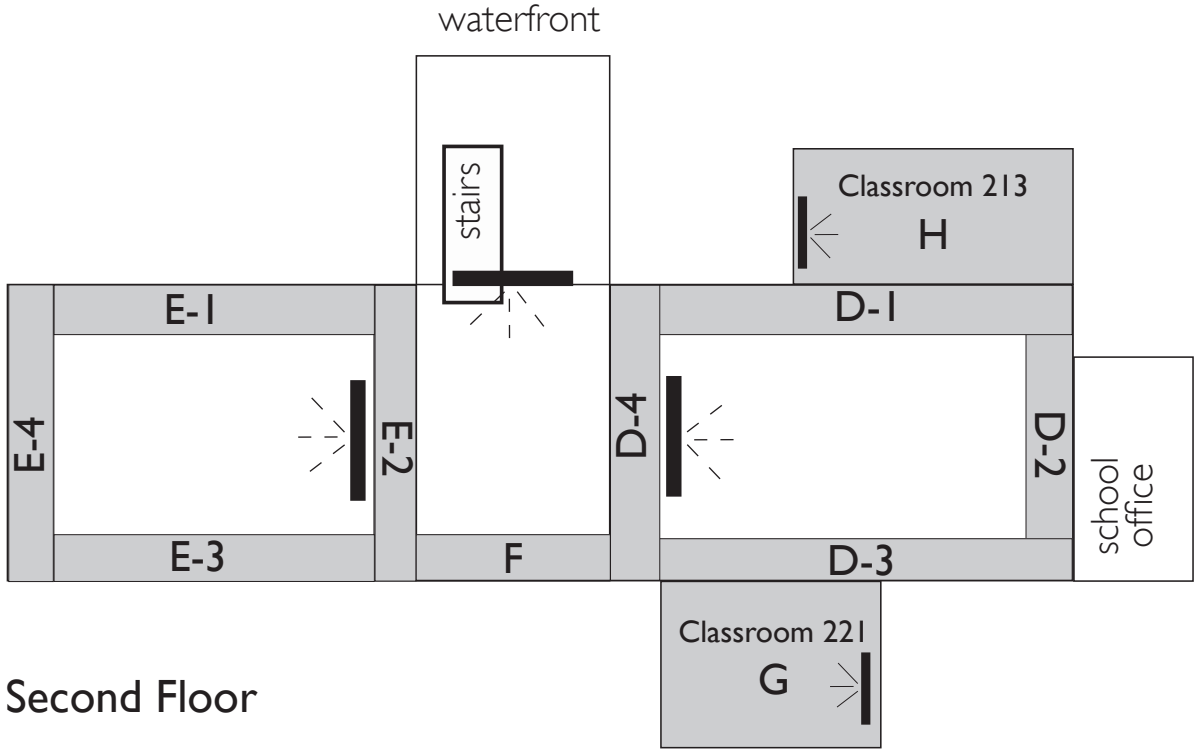

Second Floor

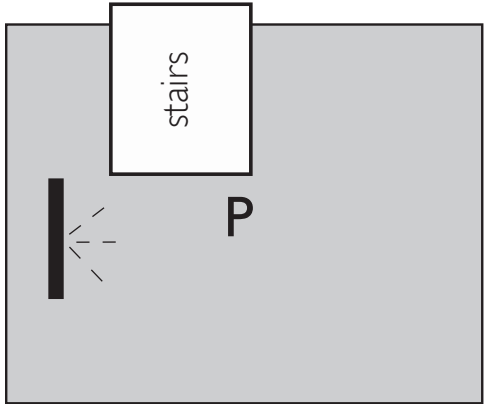

Third Floor

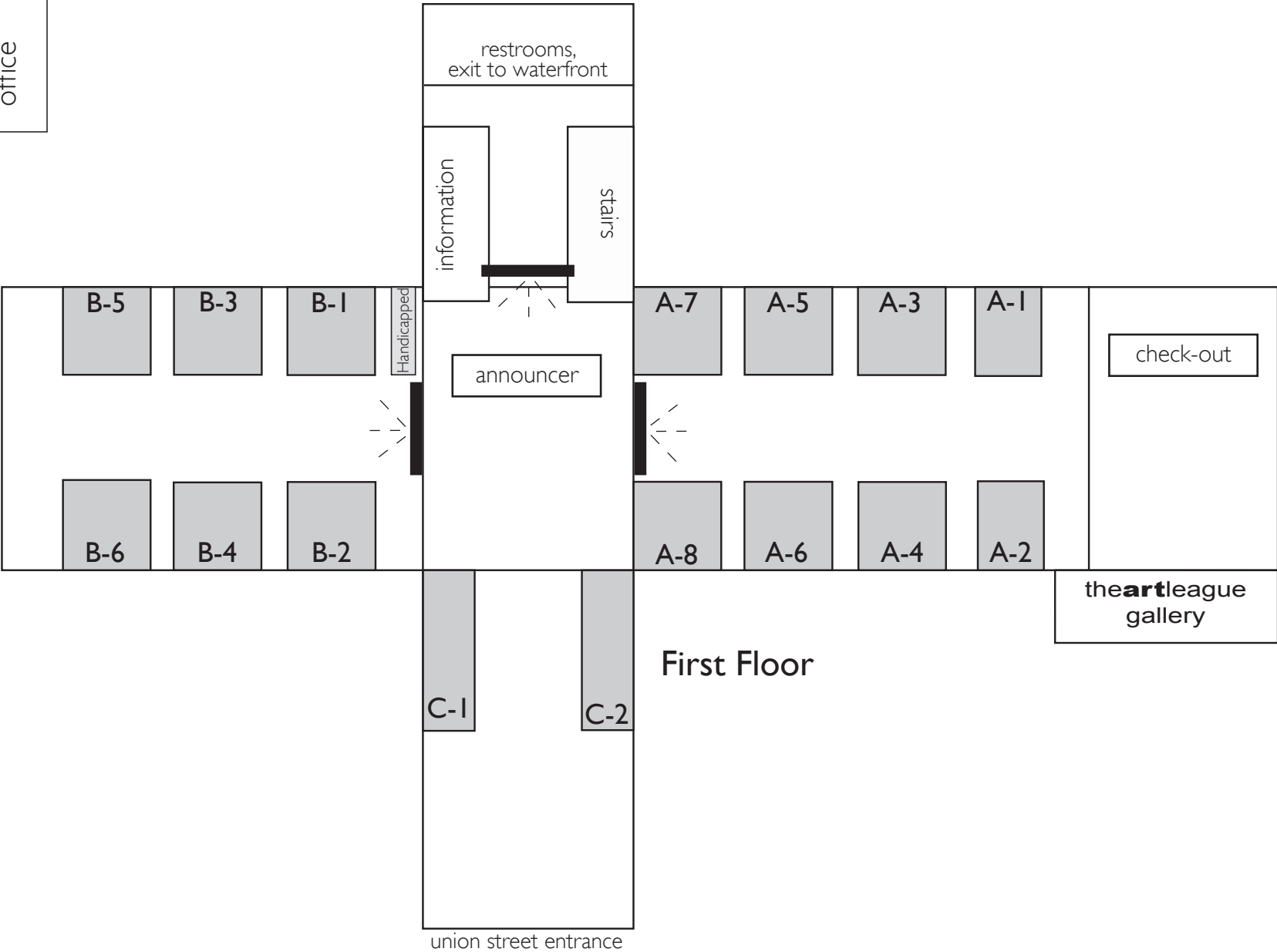

First Floor

